

technical information sheet

e-joint 265mm

Wesbeam e-joint 265mm is purpose designed for wet area floor systems.

- e-joint 265mm minimises material and labour costs
- Used in combination with 35mm packers to achieve a uniform depth of 300mm
- Available in flange widths of 63mm and 90mm – providing least cost design options
- Enables web penetrations up to 175mm in depth, assisting the transition of HVAC, plumbing and electrical conduit from 300mm deep e-joint

Figure 1 – Step Down Isometric

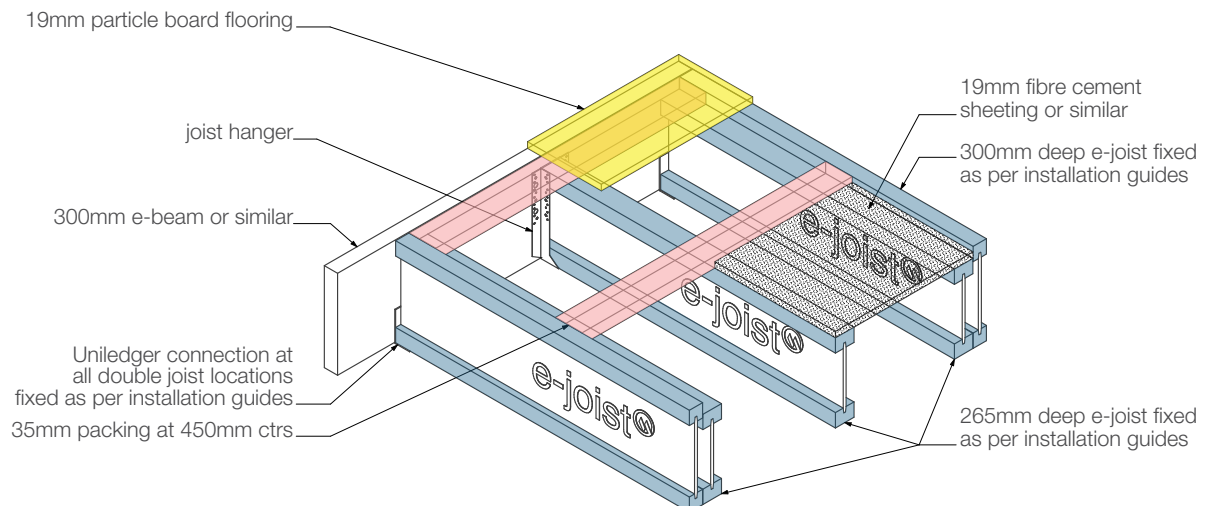

Table 1 – Recommended Floor Joists Spans (m)

Section Code	Recommended Span Range (m)		
	Single Span		
	Joist Spacings (mm)		
	300	450	600
ej265 63	4.9 to 5.9	4.4 to 5.3	4.1 to 4.9
ej265 90	5.4 to 6.4	4.9 to 5.8	4.4 to 5.3

Section Code	Recommended Span Range (m)		
	Continuous Span		
	Joist Spacings (mm)		
	300	450	600
ej265 63	5.8 to 6.9	5.2 to 6.2	4.8 to 5.7
ej265 90	6.3 to 7.5	5.6 to 6.7	5.2 to 6.2

Note: 1. The tables for single and continuous floor joists spans assume a floor load self weight of 40 kg/m² and a floor live load of 1.5 kPa (~ 150 kg/m²)
 2. For definition of continuous joist refer Wesbeam document e-joint engineered floor joists
 3. Where Setdown extends the full length of the joist select a joist span near the lower extent of the span range.

Figure 2 – Section Through Floor System Perpendicular to Joist

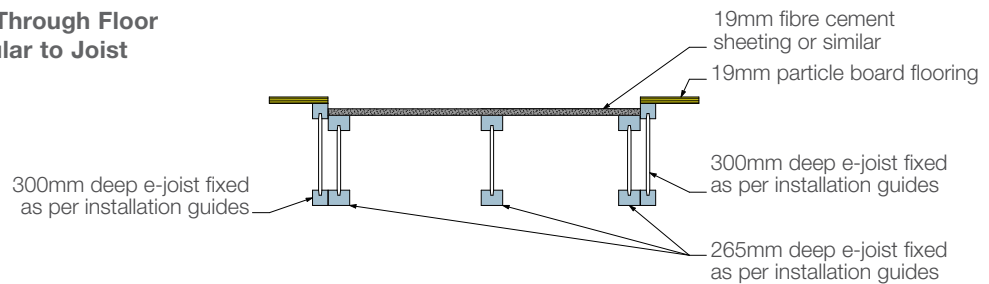
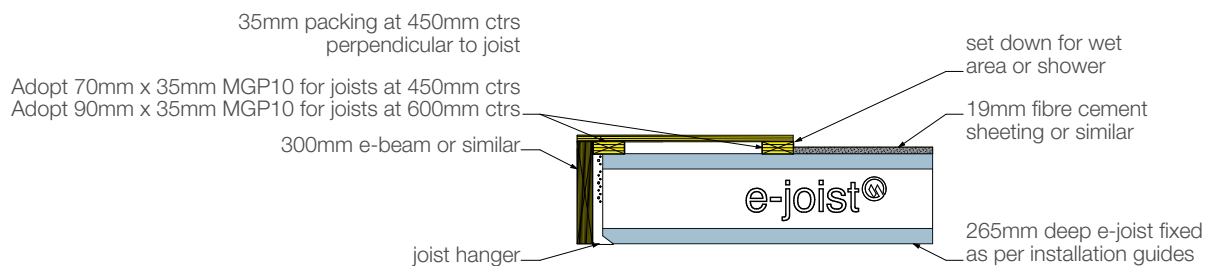

Figure 3 – Section Through Floor System Parallel to Joist



© Wesbeam Pty Limited
ABN 89 004 268 017
WESB0441 September 2020

WESTERN AUSTRALIA

190 Pederick Road
Neerabup | WA | 6031

T 08 9306 0400

F 08 9306 0444

E sales.wa@wesbeam.com

QUEENSLAND

3 Bult Drive
Brendale | QLD | 4500

T 07 3385 3900

F 07 3385 3911

E sales.qld@wesbeam.com

SOUTH AUSTRALIA

200 Cavan Road
Dry Creek | SA | 5094

T 08 8214 8500

E sales.sa@wesbeam.com

VICTORIA

Rear | 35 Greens Road
Dandenong South | VIC | 3175

T 03 8782 9500

E sales.vic@wesbeam.com

NEW SOUTH WALES

8-24 Dunheved Circuit
St Marys | NSW | 2760

T 02 8856 8400

E sales.nsw@wesbeam.com

DESIGN CENTRE

3 Bult Drive
Brendale | QLD | 4500

T 1300 356 460

E design@wesbeam.com